

<b>33412T</b>	随心雨+ 头顶花洒10"- 圆形(含Water Mind仿生驭水技术)
<b>33414T</b>	随心雨+ 头顶花洒10"- 方形(含Water Mind仿生驭水技术)
<b>33410T</b>	随心雨+ 头顶花洒12"- 圆形(含Water Mind仿生驭水技术)
<b>33411T</b>	随心雨+ 头顶花洒12"- 方形(含Water Mind仿生驭水技术)

#### 安装之前

所有的资料是按最新出版的产品资料编写而成。科勒公司保留任何时候不经通知即可改变产品特性、包装或产品可供类型的权利。

说明书包括重要的安装、保养及清洁方面的内容，请把这些资料交给用户阅读。

##### 注意事项：

1. 一定要先彻底冲洗供水管以清除管道中的杂质。
2. 推荐工作压力：1~3bar。
3. 花洒最高工作压力：0.5MPa(5bar)。水压超过0.5MPa(5bar)时必须安装减压阀。花洒最高工作温度及环境温度：60°C。请特别注意花洒同花洒连接的臂管须远离加热器，否则可能损坏花洒及其密封件，甚至对使用者造成伤害。

#### BEFORE YOU BEGIN

All information is based on the latest product information available at the time of publication. Kohler Co. reserves the right to make changes in product characteristics, packaging, or availability at any time without notice.

Please leave these instructions for the consumer. They contain important information.

##### NOTES:

1. Flush the water supply pipes thoroughly to remove debris.
2. Recommended working pressure: 1bar to 3bar.
3. The highest working pressure for showerhead is 0.5MPa(5bar). If it exceeds 0.5MPa(5bar), a pressure reducer is needed. The highest water and environment temperature is 60°C. Please keep the showerhead and shower arm away from heater, or it may become damaged and cause injury to the user.

#### 安装尺寸

#### ROUGH-IN DIMENSIONS

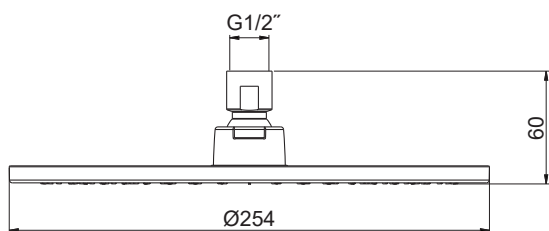

**33412T**

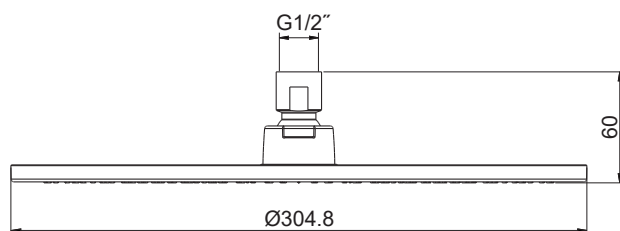

**33410T**

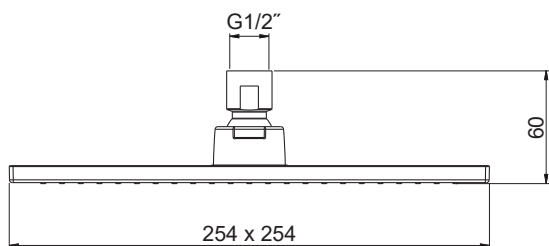

**33414T**

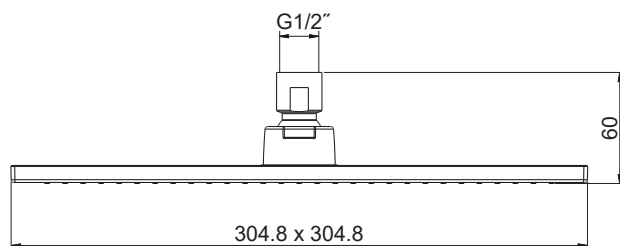

**33411T**

安装步骤

INSTALLATION

安装头顶花洒(1)之前，先打开水源冲洗掉杂质。

在花洒臂(2，客户自备)螺纹上缠绕足以密封的密封胶带或涂合适的密封胶将带有垫片(3)的头顶花洒旋到花洒臂上，并用扳手拧紧。

安装头顶花洒之前，根据需要安装限流器(4)。先取出垫片(3)，按图示方向放入限流器，再装回垫片。

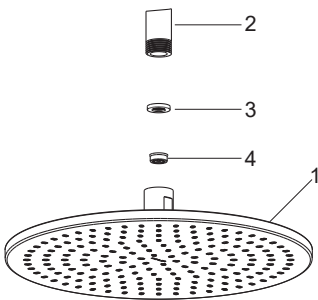

Flush both water supplies through the shower arm(2, not provided) for about one minute before the showerhead(1) is installed.

Apply tape or sealant to the exposed end of the shower arm. Install the showerhead with the washer(3) onto the shower arm, tighten them with a strap wrench.

Before installation, install the regulator(4) if needed. Take out the washer(3) and install the regulator as the figure shown, reinstall the washer.

如何清除喷孔水垢，杂质

喷孔杂质或结垢会导致水流变形，流量变小。打开水源，用力按压或摩擦橡胶喷孔，去除杂质或水垢。

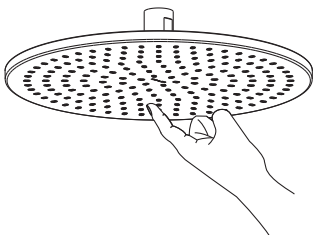

How to Clean the Nozzle

Any debris or mineral build-up may cause the flow stream to become distorted or reduce the flowrate. To remove the debris or mineral build-up, run water through the showerhead, firmly press or rub your finger back and forth across the rubber nozzles.

清洗说明

CLEANING INSTRUCTIONS

适用于所有加工处理过的表面：以中性肥皂水清洗镀层表面，再以干净的软布彻底擦干整个表面，许多清洁剂，比如氨水、去污粉及洁厕灵等，会对电镀表面造成伤害，切忌使用。

有磨损性的清洁用具或清洁剂也不可使用于科勒牌的水龙头及其配件上。

All Finishes: Clean the finish with mild soap and warm water. Wipe entire surface completely dry with clean soft cloth. Many cleaners may contain chemicals, such as ammonia, chlorine, toilet cleaner etc. which could adversely affect the finish and are not recommended for cleaning.

Do not use abrasive cleaners or solvents on Kohler faucets and fittings.

零件图

SERVICE PARTS

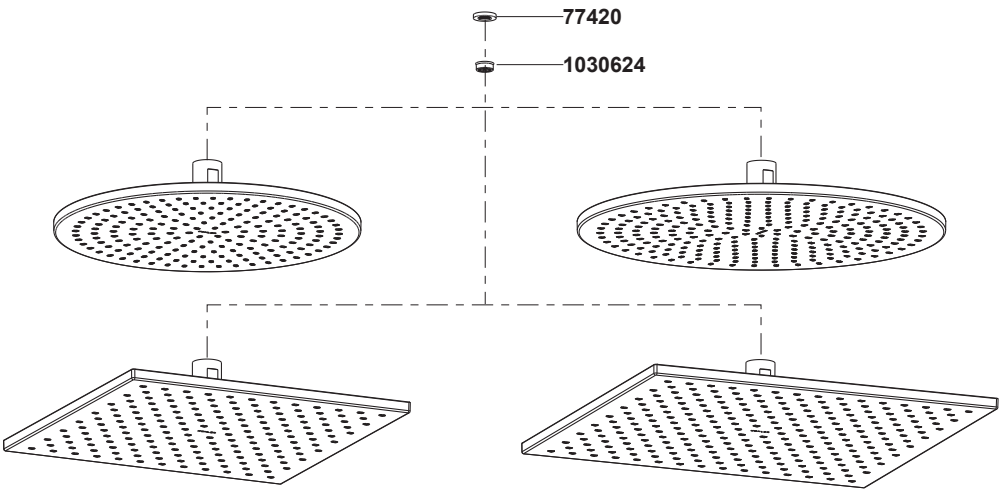

\*\*订购时请说明颜色编号  
\*\*Color code must be specified when ordering